

IGM200

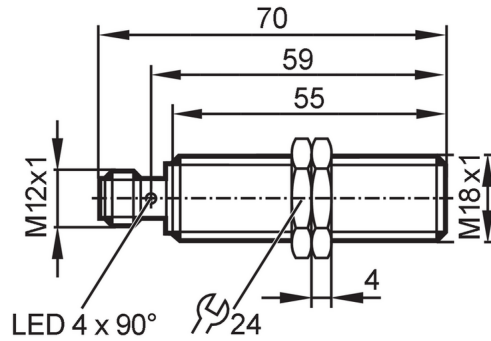

Inductive sensor

IGKC008BASKG/V4A/US-104



Product characteristics

| | | |
|-------------------|------|------------------|
| Electrical design | | PNP/NPN |
| Output function | | normally open |
| Sensing range | [mm] | 8 |
| Housing | | threaded type |
| Dimensions | [mm] | M18 x 1 / L = 70 |

Application

| | | |
|-----------------|--|---|
| Special feature | | Gold-plated contacts; Increased sensing range |
| Application | | Use in mobile and harsh applications |

Electrical data

| | | |
|-----------------------------|------|------------|
| Operating voltage | [V] | 10...36 DC |
| Current consumption | [mA] | < 10 |
| Protection class | | II |
| Reverse polarity protection | | yes |

Outputs

| | | |
|---|------|---------------------------------|
| Electrical design | | PNP/NPN |
| Output function | | normally open |
| Max. voltage drop switching output DC | [V] | 2.5 |
| Minimum load current | [mA] | 2; (only in 2-wire operation) |
| Max. leakage current | [mA] | 0.5; (only in 2-wire operation) |
| Permanent current rating of switching output DC | [mA] | 100 |
| Switching frequency DC | [Hz] | 200 |
| Short-circuit protection | | yes |
| Type of short-circuit protection | | pulsed |
| Overload protection | | yes |

Detection zone

| | | |
|--------------------------|------|--------------|
| Sensing range | [mm] | 8 |
| Real sensing range S_r | [mm] | $8 \pm 10\%$ |
| Operating distance | [mm] | 0...6.48 |
| Increased sensing range | | yes |

IGM200



Inductive sensor

IGKC008BASKG/V4A/US-104

| Accuracy / deviations | | |
|-------------------------------|--|----------------------------------|
| Correction factor | steel: 1 / stainless steel: 0.7 / brass: 0.5 / aluminium: 0.4 / copper: 0.3 | |
| Hysteresis [% of Sr] | 1...20 | |
| Switch point drift [% of Sr] | -10...10 | |
| Operating conditions | | |
| Ambient temperature [°C] | -40...85 | |
| Protection | IP 67; IP 69K | |
| Tests / approvals | | |
| EMC | automotive area | |
| | noise emission and noise immunity: ECE R10 | E1 type approval |
| | noise immunity according to DIN ISO 11452-2 | 100 V/m |
| | conducted interference in 24 V networks to ISO 7637-2: 2004 (pulse 1 to 4) and ISO16750-2: 2012 (load dump) | |
| | pulse | 1 2a 2b 3a 3b 4 Load dump |
| | severity level | III III III III III III Test A |
| | failure criterion | C A C A A C C |
| | EN 61000-4-2 ESD | 4 kV CD / 8 kV AD |
| | EN 61000-4-3 HF radiated | 10 V/m |
| | EN 61000-4-4 Burst | 2 kV |
| | EN 61000-4-5 Surge | 0,5 kV mains line to line |
| | EN 61000-4-6 HF conducted | 10 V |
| | EN 55011 | class B |
| | Fast temperature change | EN 60068-2-14 Na |
| Salt spray test | EN 60068-2-52 Kb | severity level 5 (4 test cycles) |
| MTTF [years] | 1253 | |
| UL approval | Ta | 0...40 °C |
| | Enclosure type | Type 1 |
| | UL approval no. | A051 |
| | File number UL | E174191 |
| Mechanical data | | |
| Weight [g] | 62 | |
| Housing | threaded type | |
| Mounting | flush mountable | |
| Dimensions [mm] | M18 x 1 / L = 70 | |
| Thread designation | M18 x 1 | |
| Materials | housing: stainless steel (316L/1.4404); sensing face: LCP white; LED window: PEI; lock nuts: brass white bronze coated | |
| Tightening torque [Nm] | 50 | |
| Displays / operating elements | | |
| Display | switching status | 4 x 90° LED, yellow |
| Accessories | | |
| Items supplied | lock nuts: 2 | |
| Remarks | | |
| Pack quantity | 1 pcs. | |

IGM200



Inductive sensor

IGKC008BASKG/V4A/US-104

Electrical connection - plug

Connector: 1 x M12; coding: A; Contacts: gold-plated

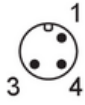

Connection

